

**IES INDOOR REPORT
PHOTOMETRIC FILENAME : L02101902.IES**

DESCRIPTION INFORMATION (From Photometric File)

IESNA:LM-63-2002
 [TEST] L0210-1902
 [TESTLAB] LIGHT LABORATORY INC
 [ISSUEDATE] 2/18/2010
 [MANUFAC] BARTCO LIGHTING, INC.
 [LUMCAT] BC206-T521-UNV-RS-T5
 [LUMINAIRE] 6-1/8"L. X 34-5/16"W. X 1-1/2"H. WALL MOUNTED FIXTURE
 [MORE] DIFFUSED AND HAMMERTONE REFLECTOR
 [MORE] WHITE SAWTOOTH REFLECTOR ON TOP
 [BALLASTCAT] UNIVERSAL B228PUNV-C
 [BALLAST] 120 TO 277V 50/60Hz ELECTRONIC
 [LAMPPOSITION] 90,90
 [LAMPCAT] SYLVANIA FP21/841/ECO
 [_LAMPLUM] 2100
 [_INPUT] 120VAC, 23.94

CHARACTERISTICS

Lumens Per Lamp	2100 (1 lamp)
Total Lumens	2100
Luminaire Lumens	1538
Total Luminaire Efficiency	73 %
Luminaire Efficacy Rating (LER)	64
Total Luminaire Watts	23.94
Ballast Factor	1.00
CIE Type	Indirect
Spacing Criteria (0-180)	N.A.
Spacing Criteria (90-270)	N.A.
Spacing Criteria (Diagonal)	N.A.
Basic Luminous Shape	Rectangular w/Sides
Luminous Length (0-180)	0.39 ft
Luminous Width (90-270)	2.86 ft
Luminous Height	0.13 ft

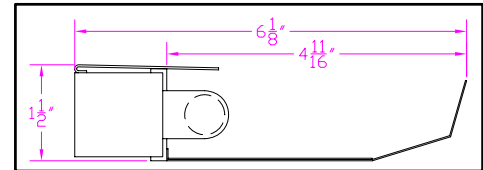

LUMINANCE DATA (cd/sq.m)

Angle In Degrees	Average 0-Deg	Average 45-Deg	Average 90-Deg
45	0	0	0
55	0	0	0
65	0	0	0
75	0	93	0
85	0	381	437

**IES INDOOR REPORT
PHOTOMETRIC FILENAME : L02101902.IES**

CANDELA TABULATION

	<u>0.0</u>	<u>22.5</u>	<u>45.0</u>	<u>67.5</u>	<u>90.0</u>	<u>112.5</u>	<u>135.0</u>	<u>157.5</u>	<u>180.0</u>
0	0	0	0	0	0	0	0	0	0
5	0	0	0	0	0	0	0	0	0
15	0	0	0	0	0	0	0	0	0
25	0	0	0	0	0	0	0	0	0
35	0	0	0	0	0	0	0	0	0
45	0	0	0	0	0	0	0	0	0
55	0	0	0	0	0	0	0	0	0
65	0	0	0	0	0	0	0	0	0
75	0	0	5	9	0	0	0	0	0
85	0	0	14	26	6	0	0	0	0
90	10	11	25	41	10	9	8	7	7
95	61	76	131	170	18	34	34	26	24
105	427	414	442	327	35	68	112	113	112
115	748	740	643	377	54	64	134	170	178
125	876	808	614	378	72	65	123	169	180
135	769	729	614	347	90	70	100	140	156
145	732	687	539	302	104	70	91	108	116
155	569	525	406	247	114	72	83	95	98
165	357	333	272	192	120	82	75	78	80
175	178	174	161	142	123	106	94	87	85
180	122	122	122	122	122	122	122	122	122

IES INDOOR REPORT
PHOTOMETRIC FILENAME : L02101902.IES

ZONAL LUMEN SUMMARY

Zone	Lumens	%Lamp	%Fixt
0-30	0	0	0
0-40	0	0	0
0-60	0	0	0
0-90	10.61	.5	.7
90-120	462.8	22	30.1
90-130	783.04	37.3	50.9
90-150	1276.07	60.8	83
90-180	1527.2	72.7	99.3
0-180	1537.81	73.2	100

Total Luminaire Efficiency = 73.2%

ZONAL LUMEN SUMMARY

Zone	Lumens
0-10	0
10-20	0
20-30	0
30-40	0
40-50	0
50-60	0
60-70	0
70-80	.9
80-90	9.71
90-100	22.28
100-110	155.86
110-120	284.67
120-130	320.24
130-140	278.42
140-150	214.61
150-160	143.77
160-170	76
170-180	31.38

IES INDOOR REPORT
PHOTOMETRIC FILENAME : L02101902.IES

COEFFICIENTS OF UTILIZATION - ZONAL CAVITY METHOD

Effective Floor Cavity Reflectance 0.20

RC	80				70				50			30			10			0
	RW	70	50	30	10	70	50	30	10	50	30	10	50	30	10	50	30	
0	70	70	70	70	60	60	60	60	41	41	41	24	24	24	8	8	8	1
1	63	60	58	55	54	52	50	48	35	34	33	20	20	19	7	6	6	0
2	58	53	48	45	49	45	42	39	31	29	27	18	17	16	6	6	5	0
3	52	46	41	37	45	40	36	32	27	25	23	16	14	13	5	5	4	0
4	48	41	35	31	41	35	31	27	24	21	19	14	12	11	5	4	4	0
5	44	36	31	27	37	31	26	23	21	18	16	12	11	10	4	4	3	0
6	40	32	27	23	34	28	23	20	19	16	14	11	10	8	4	3	3	0
7	37	29	23	20	31	25	20	17	17	14	12	10	8	7	3	3	2	0
8	34	26	21	17	29	22	18	15	15	13	11	9	7	6	3	2	2	0
9	32	23	18	15	27	20	16	13	14	11	9	8	7	6	3	2	2	0
10	29	21	16	13	25	18	14	11	13	10	8	7	6	5	2	2	2	0

POLAR GRAPH

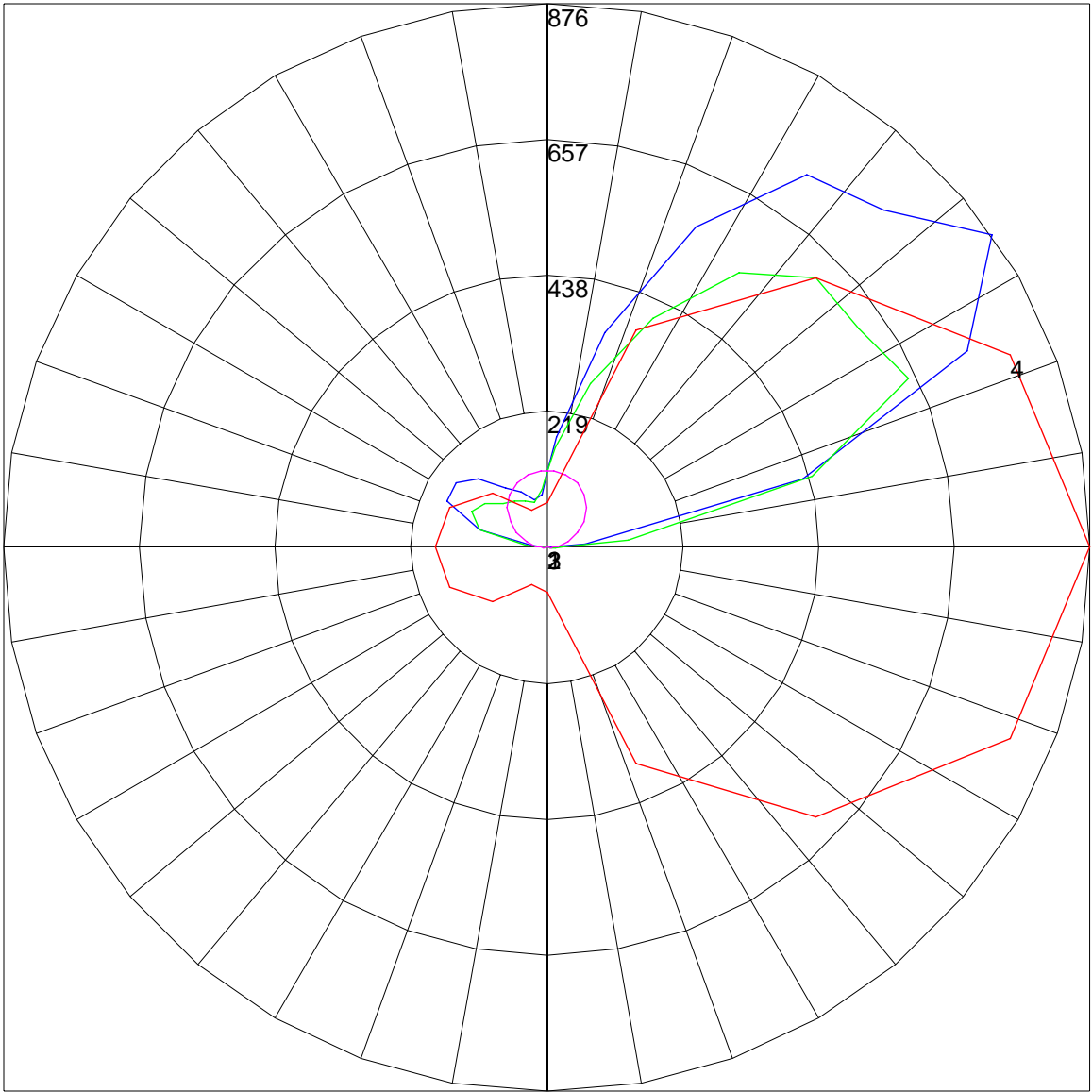

Maximum Candela = 876 Located At Horizontal Angle = 0, Vertical Angle = 125
1 - Vertical Plane Through Horizontal Angles (0 - 180) (Through Max. Cd.) : BLUE
2 - Vertical Plane Through Horizontal Angles (45 - 225) : GREEN
3 - Vertical Plane Through Horizontal Angles (90 - 270) : MAGENTA
4 - Horizontal Cone Through Vertical Angle (125) (Through Max. Cd.) : RED

NOTE: ALL TESTS ASSUME BALLAST FACTOR (BF) = 1.0 UNLESS STATED.
IF TEST OR OTHER BALLAST USED HAS A BF OTHER THAN 1.0, ALL
LUMEN, CANDELA, AND LUMINANCE VALUES SHOULD BE MULTIPLIED BY
THE BF, CU, EFFICIENCY AND % FLUX VALUES REMAIN AS LISTED.
TOTAL WATTS VALUE APPLIES ONLY TO TESTED BALLAST.