



BFL256

type: _____

LINEAR T8 FLUORESCENT

low profile T8 fluorescent fixture

- SPECIFICATIONS |**
- Fully assembled housing is formed and welded, 20 ga. steel, chemically treated to resist corrosion and enhance paint adhesion
 - Standard finish is high reflectance white powder coat, applied post production
 - Knock-outs accept standard electrical fittings (by others)
 - Available for T8 13W, 14W, 15W, 17W, 25W, 32W or 40W linear fluorescent lamps
 - Standard 120V, 277V or Universal electronic high power factor ballast is pre-wired to the lamp holders
 - Dimming and emergency battery back up options available (**consult factory for availability and system compatibility**)
 - UL and ULC listed for dry and damp locations
 - IBEW manufactured and labeled
 - Made in the U.S.A.

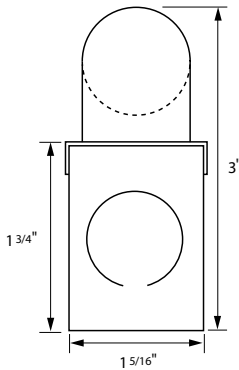

T8
architectural LIGHTING

SPECIFICATION / ORDER FORMAT			DIMENSIONAL INFO.	
model no.	voltage	options	lamp	overall length
BFL256-13	/120	Dimming - (consult factory)	13w T8	12"
BFL256-14	/277	/EB - emergency ballast (consult factory)	14w T8	15"
BFL256-15		/DL - damp location	15w T8	18"
		/CU - custom finish (consult factory)		
BFL256-17	/UNV		17w T8	24"
BFL256-25			25w T8	36"
BFL256-32			32w T8	48"
BFL256-40			40w T8	60"

LENSES | Two-piece system comprised of polycarbonate channel and striated snap-on cover



U8LNP Clear fine prismatic acrylic lens with mounting clips (sold by the foot) ___ft.
 U8LNCF Frosted acrylic lens with mounting clips (sold by the foot) ___ft.

TUBE GUARD |

TG Tube Guard (sold by the foot) ___ft.

CABLE KIT |

SEE BARTCO **CB8** FIXTURE

REFLECTORS | 20 ga. steel construction, white powder coat finish (consult factory for optional reflector materials and finishes)

SYMMETRICAL for fixture models

256-R1-13	BFL256-13
256-R1-14	BFL256-14
256-R1-15	BFL256-15
256-R1-17	BFL256-17
256-R1-25	BFL256-25
256-R1-32	BFL256-32
256-R1-40	BFL256-40

ASYMMETRICAL

256-R2-13	BFL256-13
256-R2-14	BFL256-14
256-R2-15	BFL256-15
256-R2-17	BFL256-17
256-R2-25	BFL256-25
256-R2-32	BFL256-32
256-R2-40	BFL256-40

INSIDE ASYMMETRICAL

256-R3-13	BFL256-13
256-R3-14	BFL256-14
256-R3-15	BFL256-15
256-R3-17	BFL256-17
256-R3-25	BFL256-25
256-R3-32	BFL256-32
256-R3-40	BFL256-40